

# TRIG-STAR PROBLEM LOCAL CONTEST

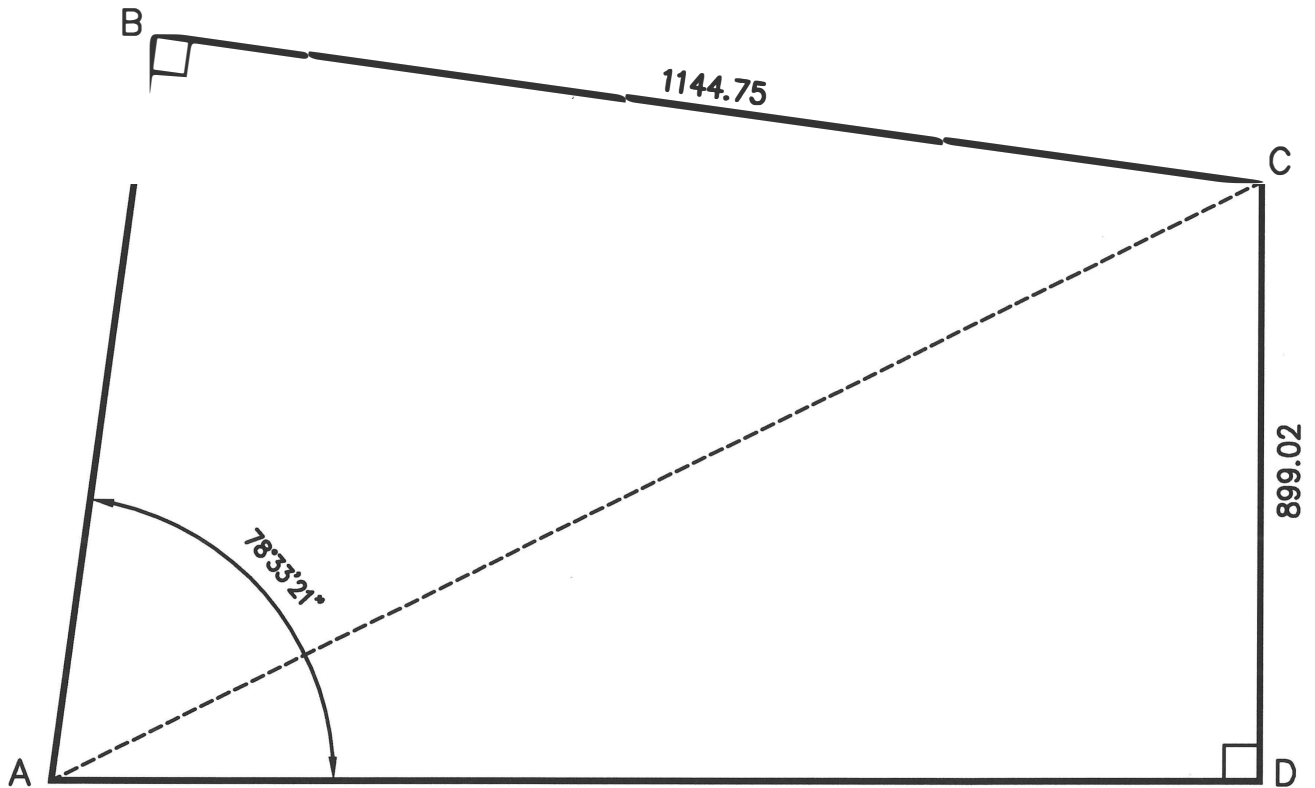

KNOWN: DISTANCE BC = 1144.75      DISTANCE CD = 899.02  
 $\angle$  BAD = 78°33'21"

FIND: DISTANCE AB = 1149.00  
DISTANCE AD = 1349.97  
DISTANCE AC = 1621.93

REQUIRED ANSWER FORMAT  
DISTANCES: NEAREST HUNDREDTH