

**Problem**

A local surveyor has been asked to stake out points D and E, where a future sidewalk will meet a new handicap curb at the corner of Meridian Road and Elm Street. The surveyor already knows the location of points B, C, and F but must make some calculations to establish and verify the points needed.

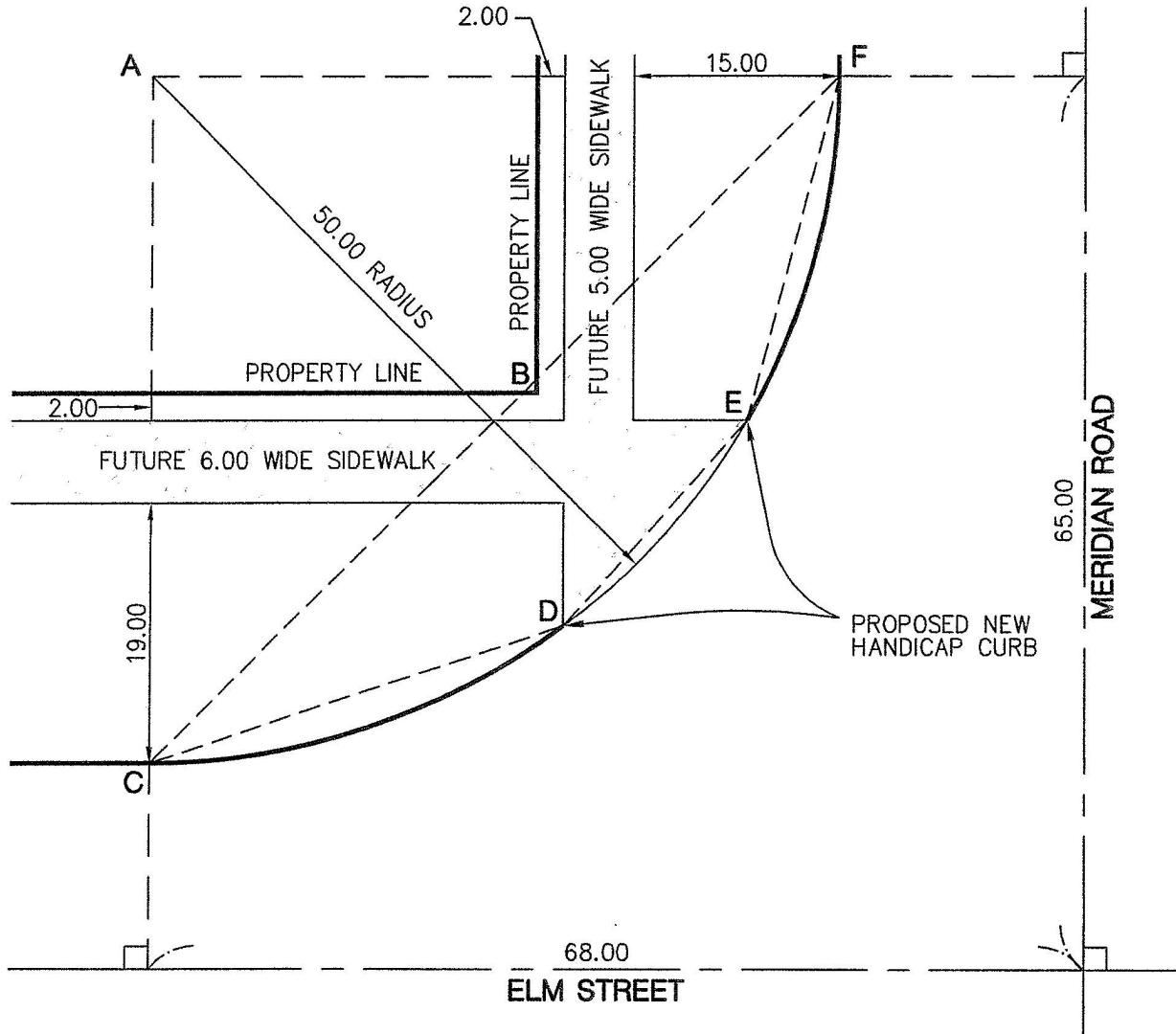

**FIND:**

DISTANCE AB = 36.24

CHORD DISTANCE CD = 31.62

CHORD DISTANCE DE = 20.05

CHORD DISTANCE EF = 25.88

CHORD DISTANCE CF = 25.88

ARC DISTANCE CF = 78.54

**Required Answer Format**

Distances: Nearest Hundredth